

270 OLD NEW BRUNSWICK ROAD

PISCATAWAY, NJ

PILOT AVAILABLE



63,250 SF
AVAILABLE

OLDNEWBRUNSWICKROAD.COM

CBRE

OVERALL SITE PLAN

**63,250 SF
AVAILABLE**

**IMMEDIATE ACCESS TO ROUTE 287.
WITHIN MINUTES OF ROUTE 18,
ROUTES 1 & 9, THE GARDEN STATE
PARKWAY AS WELL AS EXITS 9 AND
10 OF THE NEW JERSEY TURNPIKE.**

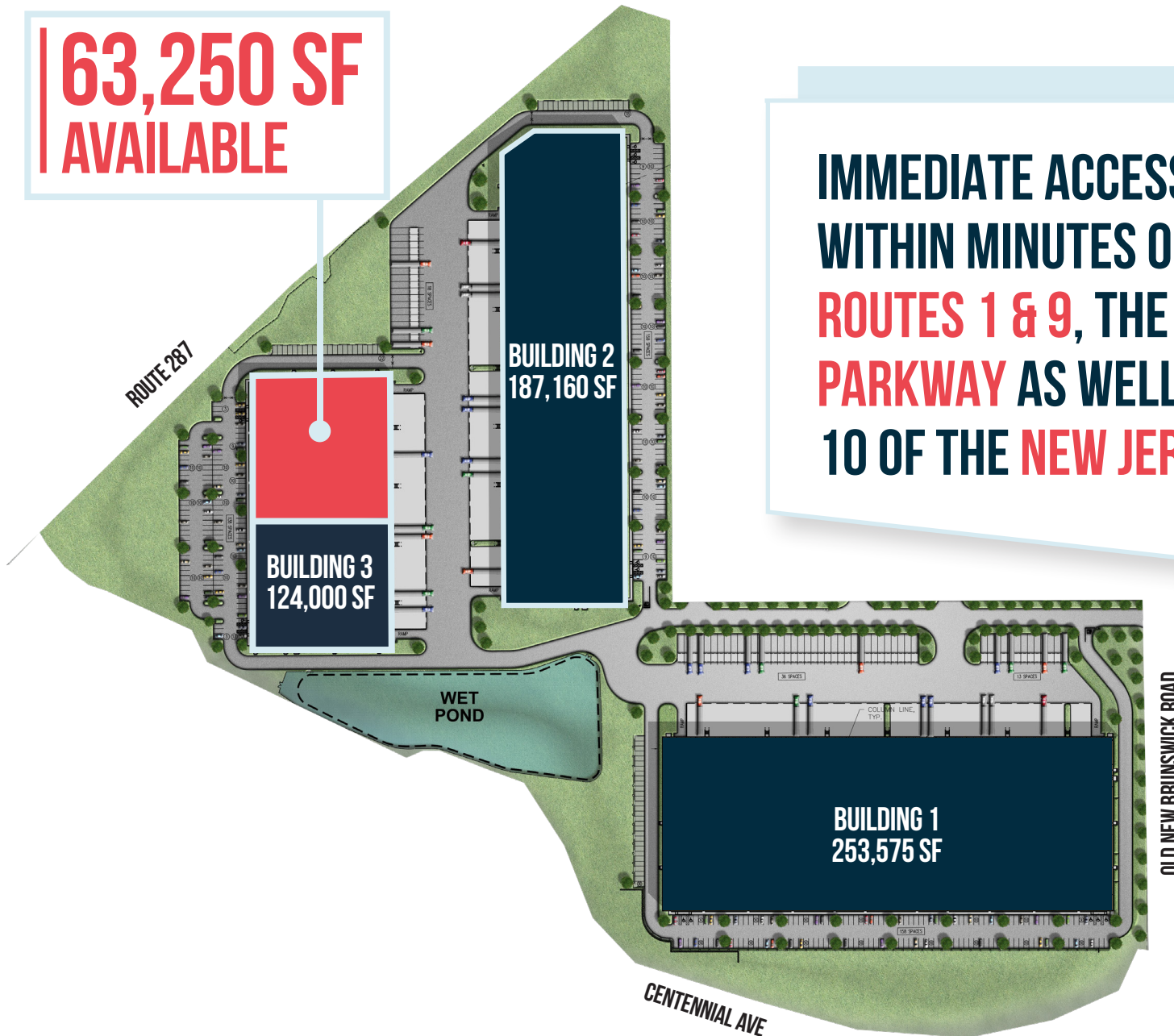

SPECIFICATIONS

TOTAL BUILDING SF	124,000 SF	BUILDING DIMENSIONS	496' X 250'	DOCK HIGH DOORS	14
AVAILABLE SF	63,250 SF	TRUCK COURT DEPTH	140' - 60' APRON, SHARED 80' DRIVE	DRIVE-IN DOORS	1
OFFICE SF	±3,200 SF	SPEED BAY	60'	POWER	600 AMPS
CLEAR HEIGHT	36'	CAR PARKING STALLS	25		
COLUMN SPACING	52' X 47'6"	TRAILER PARKING STALLS	6		

PILOT AVAILABLE
25 YEARS
REMAINING

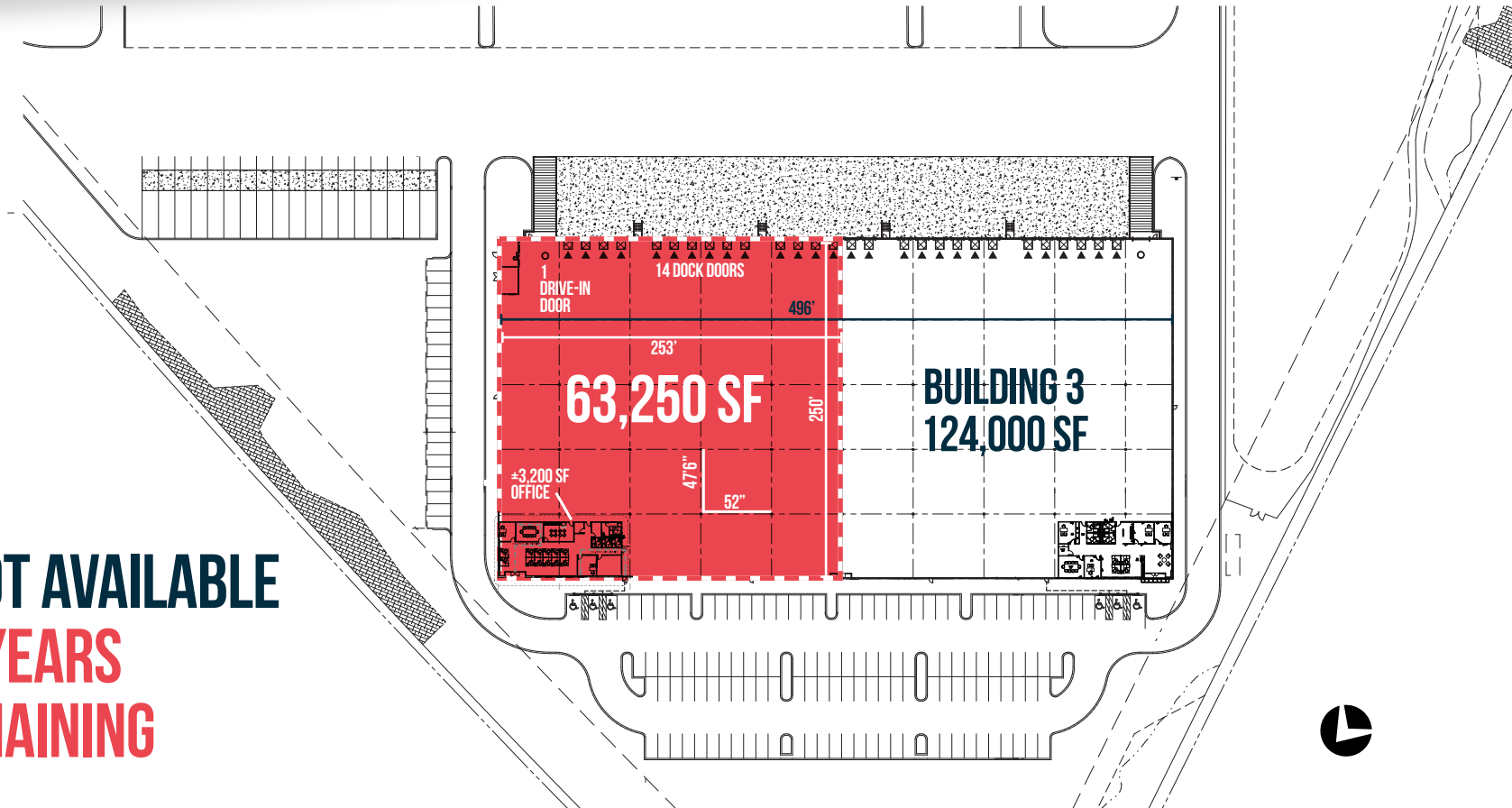

LOCATION ACCESS

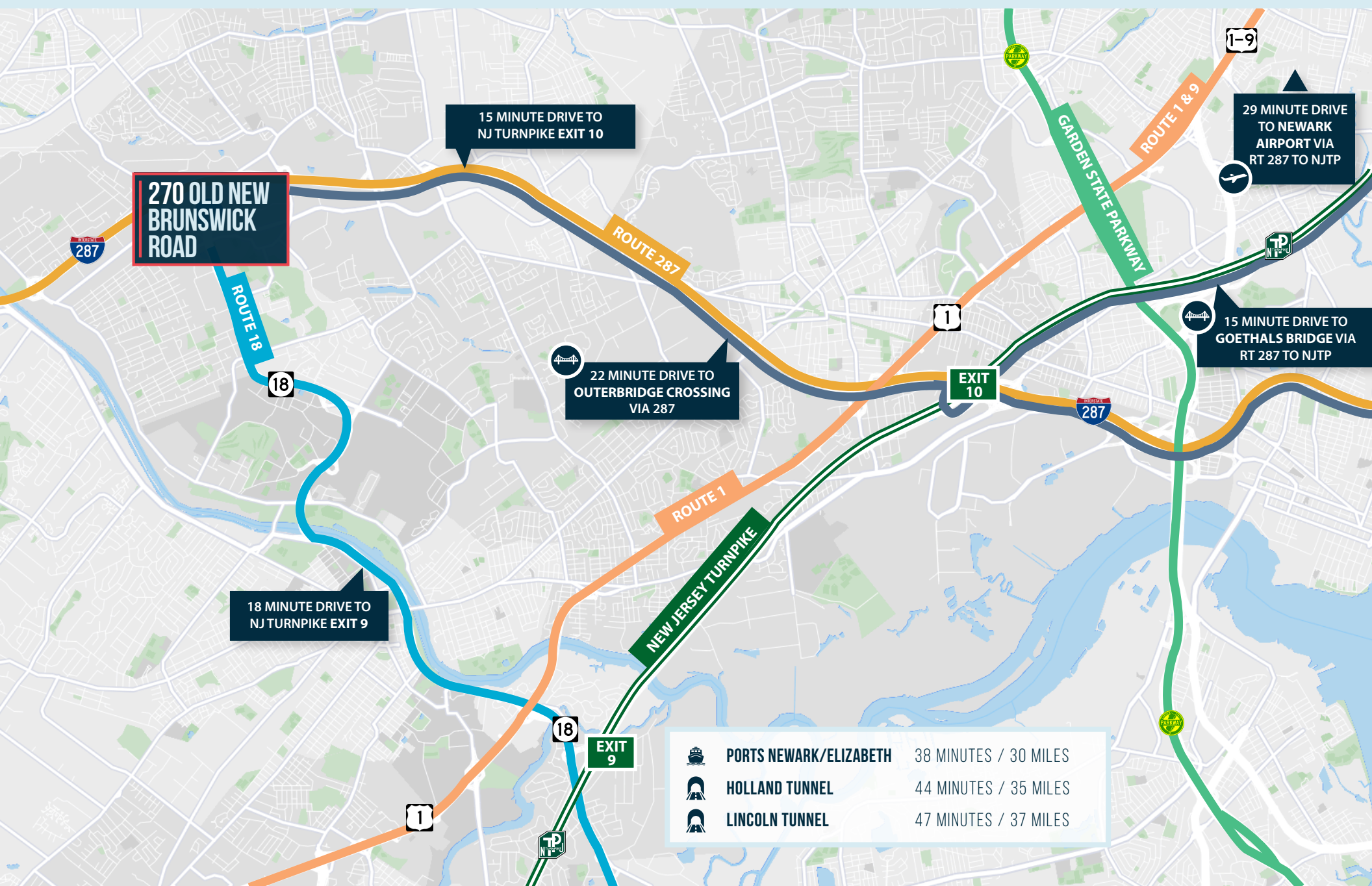

270 OLD NEW BRUNSWICK ROAD PISCATAWAY, NEW JERSEY

OLDNEWBRUNSWICKROAD.COM

THOMAS MONAHAN

Vice Chairman
thomas.monahan@cbre.com
+1 201 712 5610

LARRY SCHIFFENHAUS

Executive Vice President
larry.schiffenhaus@cbre.com
+1 201 712 5809

BRIAN GOLDEN

Executive Vice President
brian.golden@cbre.com
+1 201 712 5607

© 2025 CBRE, Inc. All rights reserved. This information has been obtained from sources believed reliable but has not been verified for accuracy or completeness. CBRE, Inc. makes no guarantee, representation or warranty and accepts no responsibility or liability as to the accuracy, completeness, or reliability of the information contained herein. You should conduct a careful, independent investigation of the property and verify all information. Any reliance on this information is solely at your own risk. CBRE and the CBRE logo are service marks of CBRE, Inc. All other marks displayed on this document are the property of their respective owners, and the use of such marks does not imply any affiliation with or endorsement of CBRE. Photos herein are the property of their respective owners. Use of these images without the express written consent of the owner is prohibited.

